

1-Gigabit Ethernet Supported

# SANUPS LAN Interface Card

Installed in a UPS, this product enables users to take necessary measures swiftly via a network. UPS status management can be done remotely from computers.

## High-Speed Communication

- This card supports 1-Gigabit Ethernet for use in high-speed, high-capacity networks such as data centers and other various network environments. Directly connected to a UPS, it enables high-speed download of collected data.

## Supports Shutdown of Various Servers

- In addition to SSH (Secure Shell),<sup>(1)</sup> this card also supports REST API,<sup>(2)</sup> which is simple and highly versatile, for shutting down servers. This enables servers that only support REST API to be shut down.

## Improved User Convenience

- The script setup wizard makes it easy to configure shutdown settings. Wireless communication<sup>(3)</sup> is supported for remote monitoring from smartphones and tablet PCs. Even without a PC, UPS operational information can be easily saved by simply connecting a USB flash drive.

(1) Communication protocol secured by data encryption.

(2) Communication method used for web communication.

(3) Requires a commercially available LAN adapter dongle that we recommend.

## ■ Usage example

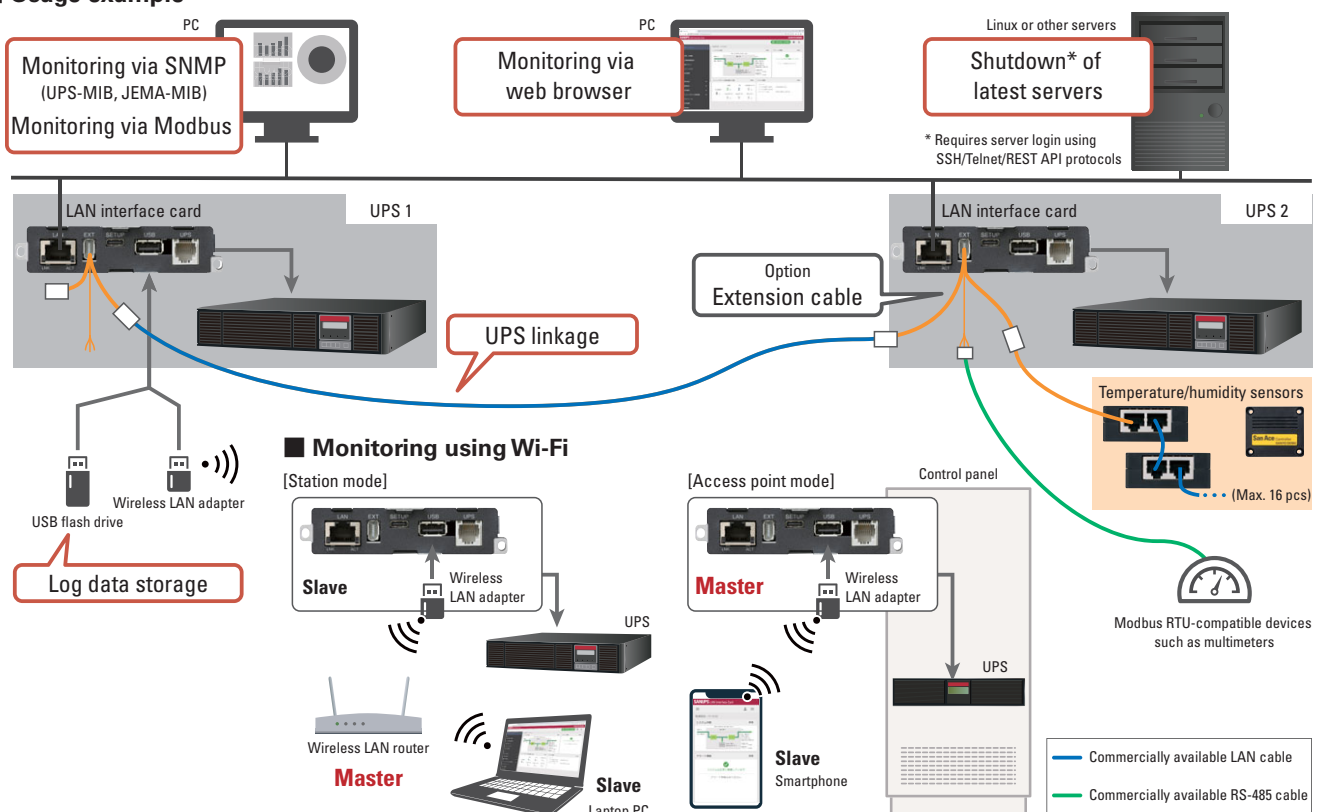

## Extended Functions with Optional Cable

- With temperature and humidity sensors connected using an optional extension cable, the temperature and humidity of the operating environment can be measured, notifying users of any changes in advance.
- With the cable, data of Modbus RTU-compatible<sup>(4)</sup> multimeters can be collected, enabling network-based monitoring of them and UPSs.
- By configuring two UPSs in linkage, the cable enables the shutdown of computers in power redundancy. Moreover, up to 5 UPSs can operate synchronously as a single power supply system.<sup>(5)</sup>

(4) Communication method used with Modbus RS-485 cables.

(5) Redundant and synchronous operations cannot be performed simultaneously.

## Specifications

|                        |                                                                                                                                                                                                                                                                                                                                                                                                                                                                                                                                                                                                                                                                                                                                                                                                                                                                                                                                                                                                                                                                                                                                                                                                                                                                         |                                                    |
|------------------------|-------------------------------------------------------------------------------------------------------------------------------------------------------------------------------------------------------------------------------------------------------------------------------------------------------------------------------------------------------------------------------------------------------------------------------------------------------------------------------------------------------------------------------------------------------------------------------------------------------------------------------------------------------------------------------------------------------------------------------------------------------------------------------------------------------------------------------------------------------------------------------------------------------------------------------------------------------------------------------------------------------------------------------------------------------------------------------------------------------------------------------------------------------------------------------------------------------------------------------------------------------------------------|----------------------------------------------------|
| Model no.              | <b>PRLANIF031</b>                                                                                                                                                                                                                                                                                                                                                                                                                                                                                                                                                                                                                                                                                                                                                                                                                                                                                                                                                                                                                                                                                                                                                                                                                                                       |                                                    |
| Functions              | <ul style="list-style-type: none"> <li>• Automatic start-up/shutdown of computers (SSH, Telnet, REST API)</li> <li>• Shutdown of computers in power redundancy<sup>(1)</sup></li> <li>• Synched stop/start of multiple UPSs<sup>(1), (2)</sup></li> <li>• Automatic computer startup at power restoration</li> <li>• Scheduled operation</li> <li>• UPS status display (Web browser and SSH/Telnet supported)</li> <li>• SNMP agent (RFC1628, JEMA-MIB)</li> <li>• Sending/Receiving emails</li> <li>• NTP (Network Time Protocol) supported</li> <li>• Downloading/Uploading UPS setting values</li> <li>• Test functions (script execution, sending emails, sending SNMP traps, shutdown)</li> <li>• Notification of events to the Syslog server</li> <li>• Measurement value threshold monitoring</li> <li>• Statistical graphs</li> <li>• Modbus master<sup>(3), (4)/slave<sup>(5)</sup> functions</sup></li> <li>• Environmental monitoring using temperature and humidity sensors<sup>(1), (6)</sup></li> <li>• Storage of collected UPS/Modbus/temperature and humidity sensor measurement data</li> <li>• Downloading operational information to a USB flash drive</li> <li>• Wireless communication (Access point mode, station mode)<sup>(7)</sup></li> </ul> |                                                    |
| LAN communication      | Transmission speed                                                                                                                                                                                                                                                                                                                                                                                                                                                                                                                                                                                                                                                                                                                                                                                                                                                                                                                                                                                                                                                                                                                                                                                                                                                      | 1000/100/10 Mbps (auto-negotiation)                |
|                        | Transmission method                                                                                                                                                                                                                                                                                                                                                                                                                                                                                                                                                                                                                                                                                                                                                                                                                                                                                                                                                                                                                                                                                                                                                                                                                                                     | Full-duplex and half-duplex (automatic), Auto-MDIX |
| Supported protocols    | TCP/IP, UDP, DHCP, SNMP (v1, v2c, v3), HTTP, HTTPS, Telnet, SSH, FTP, FTPs, SMTP (over SSL/TLS), POP3 (over SSL/TLS), NTP, Modbus RTU, <sup>(1)</sup> Modbus TCP                                                                                                                                                                                                                                                                                                                                                                                                                                                                                                                                                                                                                                                                                                                                                                                                                                                                                                                                                                                                                                                                                                        |                                                    |
| Power consumption      | 7 W                                                                                                                                                                                                                                                                                                                                                                                                                                                                                                                                                                                                                                                                                                                                                                                                                                                                                                                                                                                                                                                                                                                                                                                                                                                                     |                                                    |
| Dimensions (W × D × H) | 105 × 125.5 × 23.5 mm                                                                                                                                                                                                                                                                                                                                                                                                                                                                                                                                                                                                                                                                                                                                                                                                                                                                                                                                                                                                                                                                                                                                                                                                                                                   |                                                    |

(1) Extension cable (option) is required.

(2) Up to 5 UPSs can be synchronously controlled.

(3) Up to 16 measurement values and statuses of Modbus slaves can be monitored.

(4) Set either of Modbus TCP or Modbus RTU as a master.

(5) Both Modbus TCP and RTU can be used at the same time.

(6) Up to 16 temperature and humidity sensors can be connected.

(7) A commercially available LAN adapter dongle that we recommend can be used.

Note: To shut down computers automatically using SANUPS SOFTWARE, use PRLANIF022A or PRLANIF024A model.

## Options

### Temperature and humidity sensor

|                   |                                                                     |
|-------------------|---------------------------------------------------------------------|
| Model no.         | <b>9CT1-T</b>                                                       |
| Measurement range | Temperature: -20 to +70°C<br>Humidity 20 to 85% RH (non-condensing) |
| Mass              | 35 g                                                                |



### Dimensions (Unit: mm)

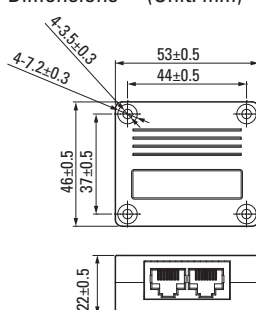

### Extension cable

|                    |                                                                                 |
|--------------------|---------------------------------------------------------------------------------|
| Model no.          | Remarks                                                                         |
| <b>CARD-CBL007</b> | For temperature/humidity sensor, Modbus RTU (RS-485), or UPS linkage connection |

